

Aerosol Filter 100 SCFM



2160 SERIES

- Designed for final clean-up of compressed air
- Utilizes media with a natural affinity for fine droplets (aerosols) of oils and water
- Adsorptive element removes even the smallest sub-micron particles and contaminants to deliver clean, dry, and oil-free air
- Recommended for end use applications having higher air consumption such as blow molding, packaging, and paint/coatings systems (Aerosol filter should be used in conjunction with an upstream coalescing compressed air filter such as the KING Air-Guard 2260)

SPECIFICATIONS

Maximum pressure	150 psi
Rated flow	100 scfm @ 100 psig; 2832 l/min @ 7 Kg/cm ² ; 170 m ³ /hr @ 7 bar
Connections	1" NPT
Filter type	Single adsorptive element
Housing	Aluminum
Efficiency	98% @ 0.1 micron
Weight	16.0 lb/7.3 kg

APPLICATIONS

- Recommended for end use applications having higher air consumption such as blow molding, packaging, and paint/coatings systems (Aerosol filter should be used in conjunction with an upstream coalescing compressed air filter such as the KING Air-Guard 2260)

ORDERING INFORMATION	
SERIES	2160-3-5 Aerosol Filter

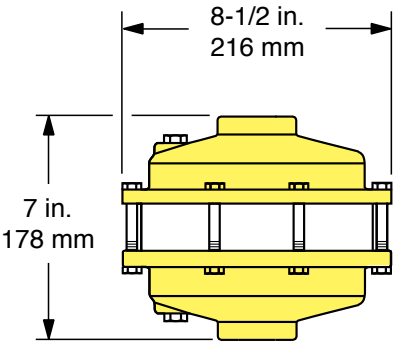

Replacement Cartridge
9326-241 - Type 750/800 Type 800 (0.1 micron)