

Indicating Polisher Cartridge 4584 Replacement Instructions

CAUTION: This cartridge is infused with a permanent dye material. Avoid accidental contamination of other objects during removal.

1. Turn off air supply and vent filter (this can be accomplished by opening sump drain).
2. Unthread upper bowl from filter body and remove old cartridge by pulling upward while twisting. (Use a rag or other material when grasping saturated cartridge.)
3. Clean any contamination present at top of filter body and bowl before installing new cartridge.
4. Install new cartridge by pushing downward with a slight twisting motion. (If possible, apply a compatible O-ring lubricant to ease installation.)
5. Upper bowl requires O-ring seal and should be firmly hand-tightened until snug.
6. Turn on air supply to filter.

ADVISORY:

Polycarbonate bowls should be cleaned using mild detergent and water only - DO NOT USE solvents!

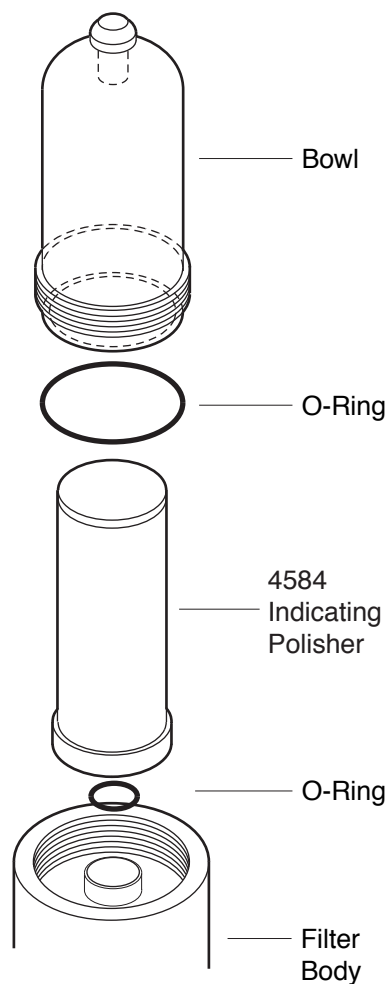

Indicating Polisher Cartridge 4584 Replacement Instructions

CAUTION: This cartridge is infused with a permanent dye material. Avoid accidental contamination of other objects during removal.

1. Turn off air supply and vent filter (this can be accomplished by opening sump drain).
2. Unthread upper bowl from filter body and remove old cartridge by pulling upward while twisting. (Use a rag or other material when grasping saturated cartridge.)
3. Clean any contamination present at top of filter body and bowl before installing new cartridge.
4. Install new cartridge by pushing downward with a slight twisting motion. (If possible, apply a compatible O-ring lubricant to ease installation.)
5. Upper bowl requires O-ring seal and should be firmly hand-tightened until snug.
6. Turn on air supply to filter.

ADVISORY:

Polycarbonate bowls should be cleaned using mild detergent and water only - DO NOT USE solvents!

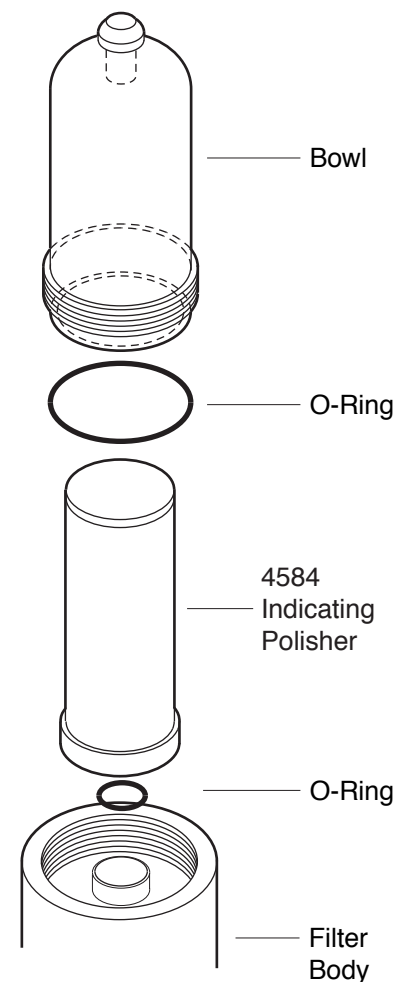

KING-GAGE, A NOSHOK Company
1010 West Bagley Road
Berea, Ohio 44017 U.S.A.
855-367-2494 www.king-gage.com



KING-GAGE, A NOSHOK Company
1010 West Bagley Road
Berea, Ohio 44017 U.S.A.
855-367-2494 www.king-gage.com